



Brakel® BA-Economy

Four-sided support

General

This system has excellent air and water tightness. The bottom profile consists of an extruded profile sealed with insulation and a drip rail. The bearing profile is tapered. This enables the drip rail to be made extremely small.

Application

The Economy system is applicable both as an insulated and an uninsulated lean-to roof or pitched roof at inclinations larger than 10° and with centre-to-centre sizes up to 1200 mm.

Aesthetics

- Profile width of both 50 mm (NA5 rods) and 60 mm (BA6 rods) for the main support direction
- Profile width 60 mm (BA6D rods) for transverse support direction
- Tube profiles and I-profiles are applicable
- Various types of glazing frames 50 mm and 60 mm wide
- Stylish lines on the outside

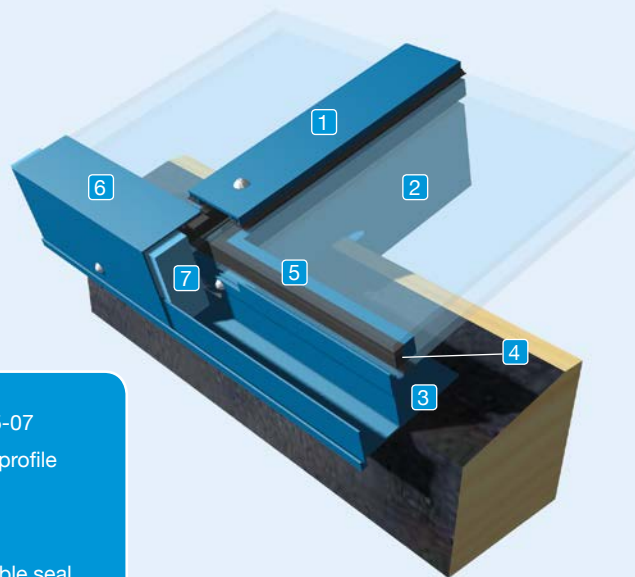

- 1 Flat glazing frame PL5-07
- 2 Tube-shaped bearing profile BA5-80K
- 3 Bottom profile EC 35
- 4 PE tape for a sustainable seal
- 5 Spacious internal gutter provides properly manageable internal water discharge
- 6 High-grade aluminium composition
- 7 Insulation material

Techniques

- The glass thickness is determined per situation using our glass and rods program
- Air permeability: NEN EN 12207: class 4
- Water tightness: NEN EN 12208: class E1050
- Aluminium profiles: EN-AW 6060 (AlMg Si 0.5)
- Aluminium sheeting: EN-AW 5005 (AlMg1; anodised)
EN-AW 5754 (AlMg3; enamelled, untreated)
- Prevention of thermal bridging
- EPDM glazing rubber 60° shore
- Surface treatment: anodise or enamel
- SS fixing materials
- Various (fire)ventilation systems can be integrated in this construction

Cross sections

The below cross-sections are just some examples in 3D and 2D.

For specific details we refer you to our website.

